

NAUTITECH 46 FLY

TECHNICAL STANDARD SPECIFICATIONS

1st SEPTEMBER 2017



TECHNICAL DATAS

Length overall	13,79 m / 45'2"
Length waterline	13,71 m 45'
Beam overall	7,54 m / 24'7"
Draft	1,45 m / 4'8"
Unloaded weight (approx.)	11,4 t / 25.133 LBS
Engine, drive	Diesel, Saildrive
Engine power	2 x 40hp Volvo Penta
Fuel tank	2 x 300L / 2 x 79 gal
Water tank	2 x 300L / 2 x 79 gal
Cabins - Heads, standard	3 to 4
Berths, standard version	6 to 8
Full batten mainsail, standard	74 sqm / 743 sq ft
Self-tacking jib, standard	38 sqm / 409 sq ft
Height of mast above water line (approx.)	22,9 m / 75'2"
Architect	Marc Lombard
Interior Design	Roseo Design

CE-Certification Category A (12 Pers.)
CE-Certification Category B (12 Pers.)
CE-Certification Category C (24 Pers.)
CE-Certification Category D (24 Pers.)



CONSTRUCTION

Hull and Deck made of fibreglass and polyester sandwich infusion- BAVARIA VacuTec process	■
Hull, Deck and coachroof in gelcoat white	■
Coloured stripe on hull, grey	■
Keel in GRP laminated and bonded to hull	■
8 x Hull windows including opening porthole	■

RIG AND DECK HARDWARE

Aluminium deck stepped mast, anodised, with two spreaders sets	■
Aluminium boom, anodised	■
Running rigging	■
3 x Lewmar Evo aluminium winch 2-gear, self-tailing on flybridge	■
2 x Winch handles and pockets	■

SAILS

Full batten mainsail (2 reef lines), Dacron	■
Self-tacking Solent in Dacron, incl. UV protection (Grey)	■

DECK/ STERN PLATFORM

Guardrail on hull sides with stainless steel wires	■
Handrails on coachroof	■
2 x Forward pulpits with seats in teak	■
6 x Mooring cleats, aluminium	■
Anodised aluminium forward beam with integrated anchor roller	■
Polyester safety net laced to hull and front beam	■
Bow anchor locker and storage	■
8 x openable deck hatches (1 additionnal in the 3 cabin version)	■
Aft pushpits	■
2 x stainless steel handrails on stern	■
2 Engine compartment hatches	■
Foldable bathing ladder on starboard	■

FLYBRIDGE

Access from cockpit, portside via stairs	■
Stainless steel handrails, around flydeck	■
Electric lever for engine control	■
Helm station with compass and s/s steering wheel	■
Helmsman seat (foldable backrest)	■
Mainsheet traveller on the coachroof	■
U-Shaped settee	■
Adjustable sunbed backrest	■
Communication Porthole between Fly and saloon	■
Rope Bags	■

COCKPIT / TRANSOM

Spacious open style cockpit, 2 large benches on starboard and portside	■
Teak grating over cockpit drainage	■
3 Large cockpit lockers	■
Aft beam lockers (liferaft dedicated)	■

PROPULSION

Soundproofing in engine compartments	■
2 x 40hp diesel engines Volvo Penta (Saildrive)	■
Diesel gauge	■
Alternators 115Ah (1 x per engine)	■
2 x 3-blade fixed aluminium propellers	■
GRP rudders with stainless steel stock	■
Stainless steel emergency tiller	■

ELECTRICAL MANAGEMENT SYSTEM

12V / 140Ah services gel batterie	1
12V / 90Ah engine batteries (no maintenance)	2
12V Electrical panel at companion-way Portside	■
230V electrical panel in aft cabin closet Portside	■
Gauge for service battery bank	■

LIGHTS

LED navigation lights and anchor light	■
LED ceilinglights in cabins, bathrooms, saloon and cockpit	■

PLUMBING

2x 85L Holding tanks (one per hull / 65L in owner cabin)	■
2x 300L freshwater tanks	■
Pressurised water system	■
Indicator for freshwater	■
Electric and manual bilge pumps in both hulls	■
Electric bilge pumps in both engine compartments	■

INTERIOR LAYOUTS

Available versions

4 Cabins

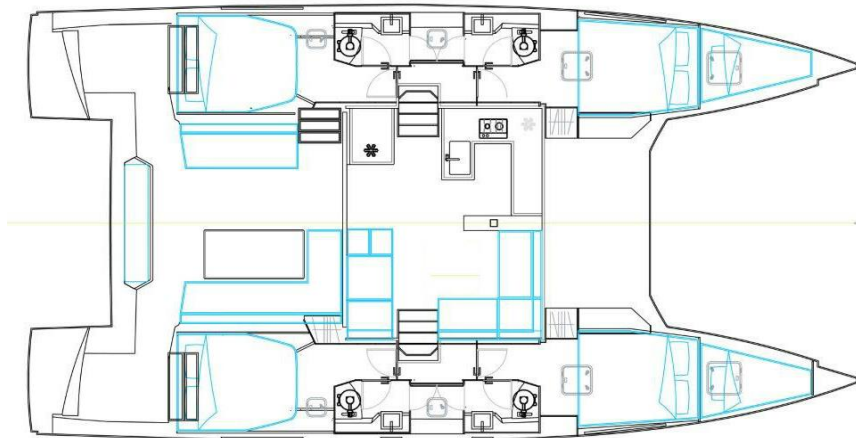

3 Cabins - Owner Version

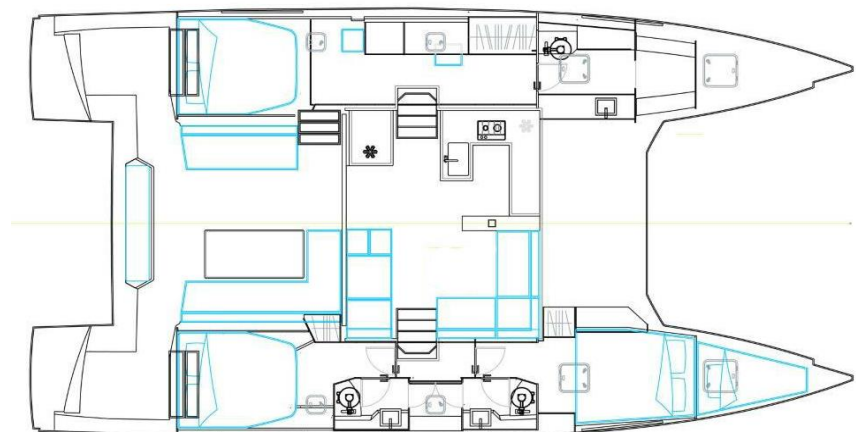

Generalities

Interior woodwork in Alpi White oak
 Walnut nature Flooring
 GRP - White
 Headliner Silvertex Macadamia

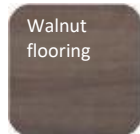

Saloon

Comfortable saloon area with modern lounge style sofas	■
3 part sofa with storage (+ 2 extra sitting ottoman)	■
Storage under the seats	■
Fabric upholstery : see 'Comfort' range	■
Double sliding doors, lockable	■

Galley

Multiple storage cupboards	■
Large worktop (standard HPL compact white)	■
3 burner gas stove	■
Separate Gas oven	■
Double sink with mixer tap	■
Waste bin	■

Cabins

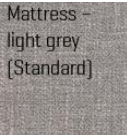
Aft cabins with Double bed (160*200cm)		■
Forward cabins with Double bed (140/165*200cm)		■
Mattresses Light Grey with washable cover		■
Several spacious lockers and shelves for storage		■
Wall unit		■
Shelf on outer side of hull		■
Side Lining Macadamia Silvertex		■
12V LED reading lights headboard		■
One opening portlight in hullwindow per cabin		■
Opening deck hatch (1 per cabin)		■

Owner Cabin equipment (in addition to above cabin description)

Access from the saloon through a sliding door	■
Working area : Fold down desk with seat	■
Large lockers with three doors	■
Opening deck hatch	■
One opening portlight in hullwindow above desk	■

Head (1 per cabin)

Separate shower cabin per hull (incl.mixing tap and support)	1
Sink with mixing tap	■
Black worktop	■
Cabinet for storage	■
Towel rail	■
Mirror	■
Pump-toilet, manual	■
Opening portlight	■
Opening deck hatch	■

Owner head

Separate shower cabin	■
Sink with mixing tap	■
Large cabinets for storage	■
Mirrors	■
Towel rail	■
Pump toilet, manual	■
Opening portlight	■
2 x Opening deck hatches (above shower cabin and bathroom)	■

Passage way

Storage cupboards (optional space for washing machine or icemaker on starboard)	■
---	---

All weights and measurements are calculations based upon construction documents. The brochure is intended for advertisement only and is not part of a contract, warranty or of an offer. We reserve the right to modify or improve our products and to change specifications without notice. We are not liable for errors and printing mistakes. All rights are reserved to execute alterations in construction and equipment without notice. Aforementioned prices are recommended sales prices for deliveries ex works within 4 months of order placement. Later deliveries are subject to invoicing according to the then valid price list.



Version 06/2017 - Valid as of September 1st 2017

Date of issue : 1st Sept 2017- the previous list loses its validity.